

LMC-J-0030

Crane collision avoidance system

This robust device ensures that overhead cranes are under control at all times; preventing costly collision with other moving cranes or building walls.

Can your business afford to be without it!

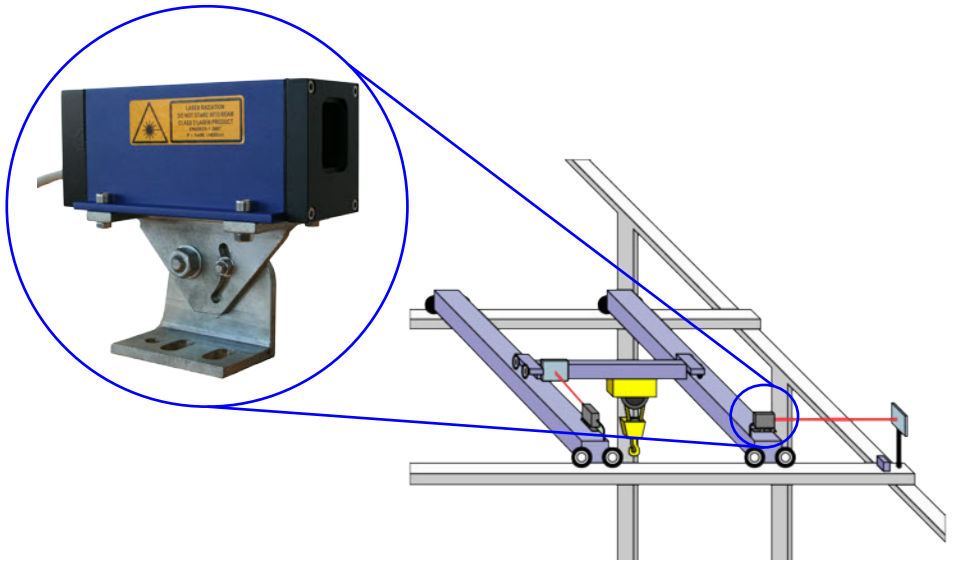

- 0.2 - 150 metres range
- Three alarm outputs Warning, Slow & Stop
- Fault monitor output
- Compact & rugged: IP66
- Intuitive setup with "teach function"
- No need for reflectors (range to 30m)

Specification:

LMC-J-0030 Crane Collision Avoidance System	
Supply Voltage:	18-36VDC (max power consumption 5W at 500mA)
Relay Output 1,2,3:	250VAC 3A, $\cos\phi=1$ unexcited & LED on when at setting distance
Relay Output 4:	250VAC 3A, $\cos\phi=1$ unexcited & LED on when error condition
Light Source:	650nm laser diode; red light
Laser Class:	Class 2 IEC825-1/EN60825, Class II FDA21 CFR
Output Power:	<1mW
Laser Divergence:	0.6 mrad
Beam Diameter	<6mm @ 10m, <30mm at 30m
Measuring Range:	0.2m-30m (natural surfaces) upto 150m (special reflector)
Measuring Accuracy:	$\pm 3\text{mm}$ ($\pm 2\text{mm}$ under defined conditions)
Repeatability:	$\leq \pm 0.5\text{mm}$
Resolution:	1mm
Measurement Time:	100ms
Operating Temperature:	-10 °C to +60 °C
Protection:	IP66

Dimensions:

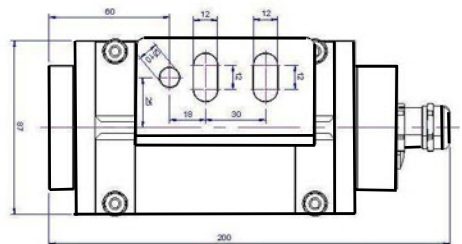
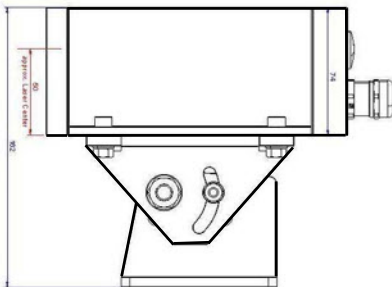

1010 Cambourne Business Park, Cambridge, CB23 6DP UK.
 Tel +44 (1223) 923 930 : Fax +44 (1223) 923 940 info@sentekeurope.com :
 www.sentekeurope.com